

RECESSED HOUSING

Fixtures are classified for insulated ceilings-type IC and type T- and for suspended ceilings-type S. TO insure safe and reliable operations, make sure the fixture corresponds to the carefully before beginning installation

In general these instructions apply to "round" housings. In most cases drawings of "round" housings have been used to illustrate installation procedures. Before attempting installation of any recessed lighting fixture check your local electrical code. This code sets the wiring standards for your locality and should be carefully studied before starting work

INSULATED CEILINGS

IC
Type

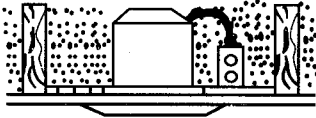

Insulated Ceiling

The insulated ceiling or I.C. approved recessed fixture is one that can be installed in direct contact with insulation

T
Type

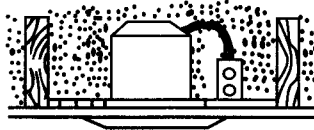

Thermal Protected

Thermal protected fixture is designed for installation where will not come in direct contact with insulation. Thermal insulation must be kept 3" away from housing includes a thermal protector that deactivates the unit if an incorrect lamp is used or if insulation is too close to the fixture.

S
Type

SUSPENDED CEILINGS



Suspended Ceiling

Fixture can be installed in suspended ceilings that are not permanent or insulated.

WARNING-RISK OF FIRE. MOST DWELLINGS BUILT BEFORE 1985 HAVE SUPPLY WIRE RATED 60°C. CONSULT A QUALIFIED ELECTRICIAN BEFORE INSTALLING.

NEW CONSTRUCTION INSTALLATION.

1. BAR HANGERS

Insert bar hangers into the slots on the plaster frame (drawing 1). Position bar hangers so that nail in tabs point away from housing or point down to ceiling.

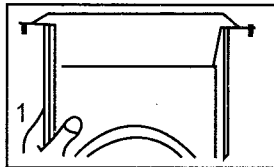

3. ELECTRICAL CONNECTION

Junction box contains two wires. A Black (hot+) and a white (neutral-). Which must be spliced to the house current feed wires. Make sure to splice white to white and colored or black to black. After splicing has been completed, tuck splices carefully into junction box and replace cover (drawing 4)

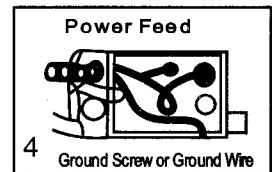

2. FASTENING FIXTURE TO CEILING

Joist-type ceiling-extend bar hangers to fit between joists. Position fixture temporarily by hammering "nail-in" tabs into joists (drawing 2), then secure permanently with nails. Hangers should be level with bottom of joists. Suspended (T-bar) ceilings-extend bar hangers 1" past T-bars. then rest fixture on T-bars. Secure fixture to T-bars with wire

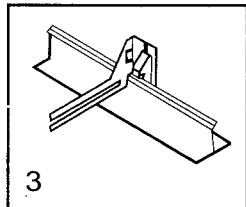
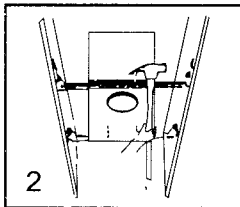

Grounding

For Romex or 3 wire BX, Flexible Armour cable installations, attach supply ground lead (green) to bare copper ground lead or ground screw in wiring box mounted on plaster frame. Local electrical codes should be consulted to determine acceptable installation-conduit Romex, or flexible Armour cable.

4. CUTTING A HOLE

Locate the center of proposed opening on your tile or ceiling material and mark it. Rounds: Use a compass to draw a circle around the center point. Cut along this circular line (drawing 5).

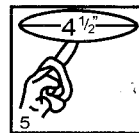

4" HOUSING

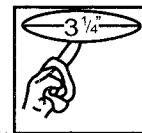

3" HOUSING

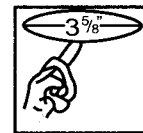

3.5" HOUSING

REMODEL HOUSING

- 1). Cut Hole: 4 1/2" (4" Housing), 3 1/4" (3" Housing), 3 5/8" (3.5" Housing)
- 2). Open Junction box and connect the wires including the ground
- 3). Pass the fixture through the hole and position accordingly.
- 4). Push fastening clips through the slots provided.
- 5). Fasten by tightening the clip.

