



To prevent death, injury, or damage to property, this product must be installed in accordance with the National Electrical Code (NFPA 70) in the US or the Canadian Electrical Code (CSA 22.1) in Canada.

Risk of fire or electric shock. The electrical rating of these products is 120–277 Vac; the installer must determine whether they have 120–277 Vac at the luminaire before installation.

Risk of fire or electric shock. LED Commercial High Bay installation requires knowledge of luminaire electrical systems. If you are not qualified, do not attempt installation. Contact a qualified electrician.

To prevent wiring damage or abrasion, do not expose wiring to the edges of sheet metal or other sharp objects.

Disconnect power before installing the product or servicing it.

Wait until the fixture has cooled down before installing or servicing it.

MIN. 90°C SUPPLY CONDUCTORS

Components required for installation

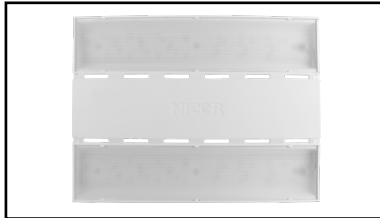

One (1) HML1100U and HML1150U

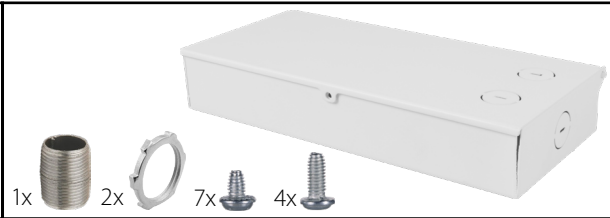

One (1) HML1EMBOX0818 with one (1) NPT male conduit, two (2) conduit locknuts, seven (7) short screws & four (4) long screws.



One (1) set of EMS081WRV (8 WATT), or EMS181WRV (18 WATT)

Tools Needed

The emergency battery pack and enclosure require very few tools for installation. A screwdriver, a pair of wire cutters, and a power drill will help install the emergency battery pack and enclosure.

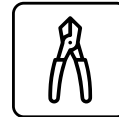
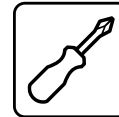

Installation Instruction

- 1 Carefully unpack the fixture and accessories from their packaging. Inspect the product for defects due to shipping.

- 2 Remove one of the K.O.s at the back to prepare for the EM wiring and prior to the installation of the EM enclosure (HML1EMBOX0818). Ensure that you are removing the K.O. that is aligned to the EM enclosure wire access hole to avoid any misalignment.



- 3 Install and secure the HML1EMBOX0818 to the back of the fixture with four (4) long screws that are included in the package of the emergency enclosure.



- 4 Remove all the screws from the fixture back plate for easy access for wiring and installing the NPT conduit and locknuts.



- 5 Using the 1/2 NPT male straight conduit nipple and two (2) pieces of 1/2 conduit locknuts, secure the K.O. wire access holes from the emergency enclosure to the fixture itself. Ensure that both ends are tight and locked.

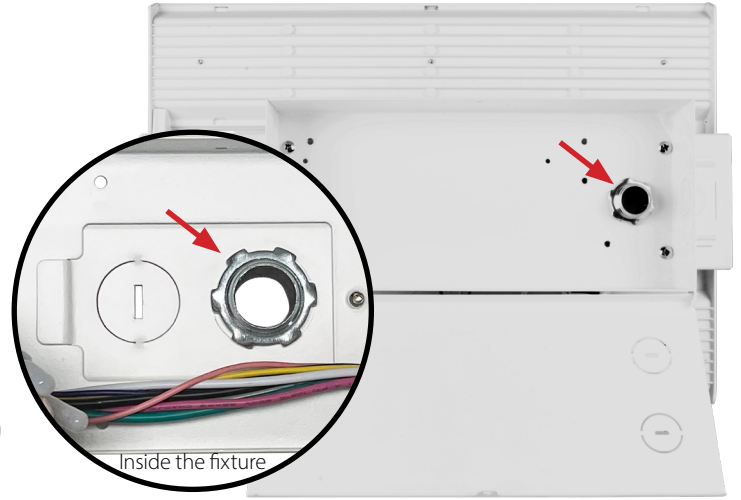

- 6 Verify which Emergency Driver to use based on what fixture is being used. See the product compatibility list below. Only used the correct emergency pack accordingly.

PRODUCT COMPATIBILITY LIST

Emergency PN #	Description	Product Compatibility	EM Enclosure Compatibility
EMS081WRV	8W Battery Pack (120-347V)	HML1100U***	HML1EMBOX0818
EMS181WRV	18W Battery Pack (120-347V)	HML1100U***	
		HML1150U***	

The compatibility list is subject to change without notice.

- End user is responsible for proper selection of battery pack to meet NFPA requirements
- Emergency is not available on HV fixtures.

- 7 Screw the emergency battery into the enclosure using the four (4) short screws and two (2) screws for the emergency driver. Once secured, insert the wiring through the fixture.

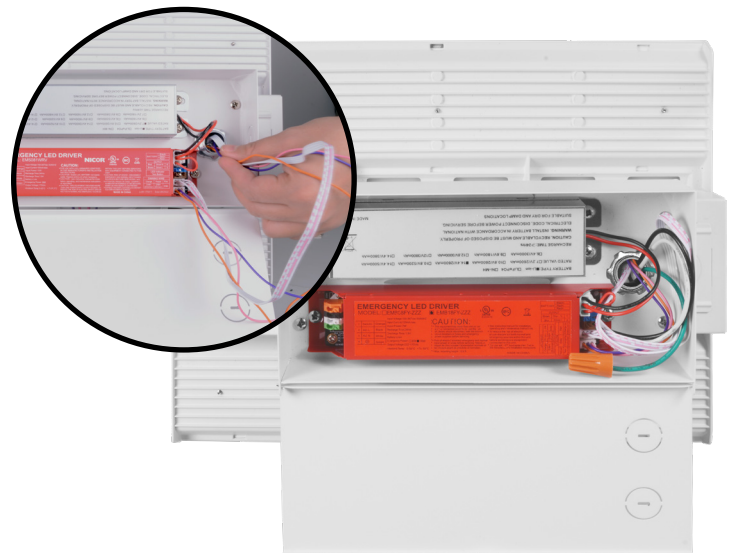

- 8 Open the back of the HML fixture to wire all the necessary configurations. Refer to the Emergency Driver (EMS081WRV or EMS181WRV) installation instructions to see all types of wiring configurations based on needs.

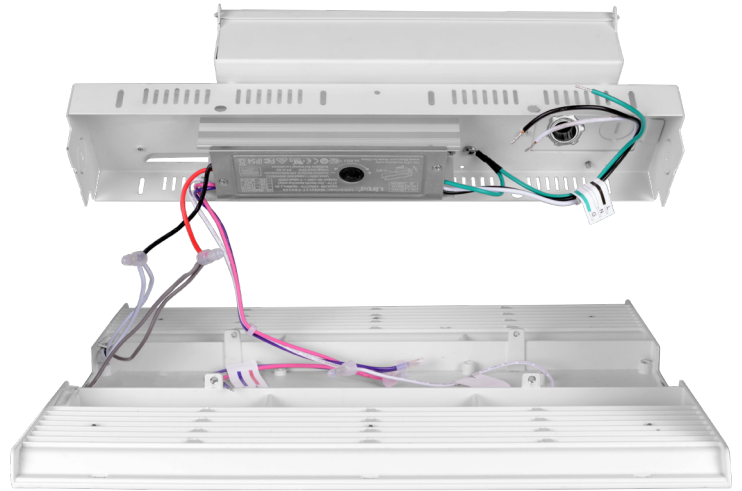

- 9 When installing the emergency switch. Drill a half-inch-diameter hole for the emergency switch mounting. The EM switch hole can be found beside the sensor holes.

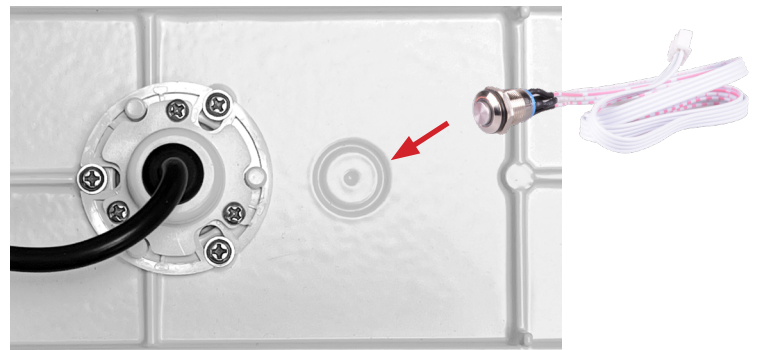

- 10 Screw in and secure the Emergency Switch through the hole.

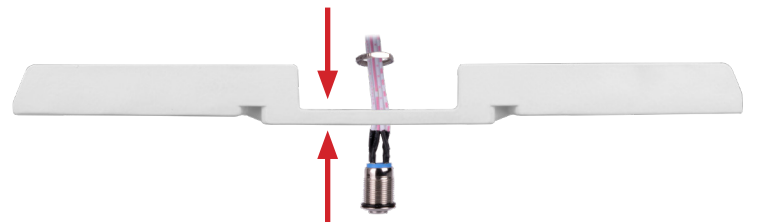

- 13 Secure all covers when complete. Use the last short screw is to secure the EM enclosure lid.

1x 

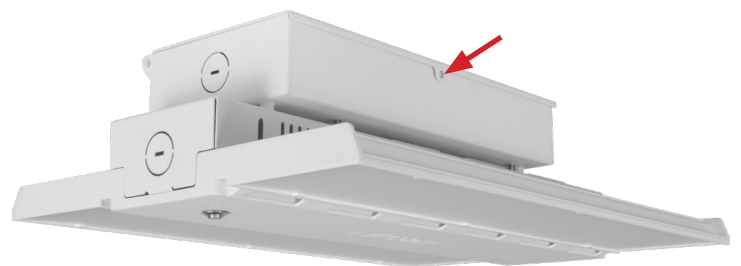



HML1EMBOX0818

HML EMERGENCY ENCLOSURE INSTALLATION INSTRUCTIONS

HMLv1 100W, 150W

This device complies with part 15 of the FCC Rules. Operation is subject to the following two conditions: (1) This device may not cause harmful interference, and (2) this device must accept any interference received, including interference that may cause undesired operation.

NOTE: This equipment has been tested and found to comply with the limits for a Class A digital device, pursuant to part 15 of the FCC Rules. These limits are designed to provide reasonable protection against harmful interference when the equipment is operated in a commercial environment. This equipment generates, uses, and can radiate radio frequency energy and, if not installed and used in accordance with the instruction manual, may cause harmful interference to radio communications. Operation of this equipment in a residential area is likely to cause harmful interference in which case the user will be required to correct the interference at his own expense.

NICOR LED Express Limited Warranty

Subject to the exclusions below, each NICOR LED product, including the LED electronics and components of a property installed NICOR LED product, will be free from defect in materials and workmanship for a period of five (5) years from the original date of purchase. The product shall be considered defective only if 10% or more of the product's LED components fail. NICOR LED product warranty covers the following performance criteria: LED Light Output will be maintained above 70% of initial output; LED color temperature will not shift more than 200K in CCT; LED driver will operate within NICOR specifications; and the fixture finish, excluding natural aluminum or brass products, will not exhibit cracking, peeling, excessive fading, or corrosion during the warranty period. Exceptions apply as defined in NICOR's product specification sheets, which are incorporated by reference herein. This limited warranty is provided to you, the purchaser of the product identified on Seller's invoice, as your exclusive remedy and applies only to NICOR products that have been purchased from an authorized NICOR Distributor; the product was new and in an unopened NICOR package at the time of installation; and the NICOR product was installed by a licensed electrician or under the supervision of a licensed electrician and used by consumers in the United States or Canada when accompanied with this warranty. This warranty extends only to the first consumer purchaser and is not transferable. A consumer wishing to invoke the terms of this limited warranty must first obtain a RGA number within 30 days of discovery of the defect, and return the product to NICOR for inspection. Once verified to be covered by this limited warranty, NICOR will, at its sole discretion, repair, replace, or refund the purchase price of any product that does not conform to this limited warranty. If NICOR, at its sole discretion, determines that the product should be repaired or replaced, this warranty is limited to the reasonable, customary, and necessary costs and expenses associated with the repair/replacement. This warranty requires that all repair/replacement estimates and costs, including but not limited to equipment rental (if any), and any other cost or expense to be incurred in the repair/replacement of the product, be approved in advance and in writing by NICOR.

FAILURE TO OBTAIN NICOR'S ADVANCE WRITTEN APPROVAL OF ALL REPAIR/REPLACEMENT COSTS AND EXPENSES IN WRITING SHALL VOID THIS LIMITED WARRANTY. THIS LIMITED WARRANTY DOES NOT COVER THE FOLLOWING:

- Defects or damages resulting from improper installation, operation, storage, misuse or abuse, accident, or neglect;
- Defects or damages resulting from improper service, testing, adjustment, installation, maintenance, alteration, connection to out-of-specification electrical service, corrosive or damp environments, or connection to incompatible equipment or devices (e.g., connecting non-dimmable lighting products to dimmers);
- Damage which occurs in transit;
- Power surges or overheating due to external conditions
- Acts of nature including but not limited to lightning strikes

ANY IMPLIED WARRANTIES, INCLUDING WITHOUT LIMITATION, THE IMPLIED WARRANTIES OF MERCHANTABILITY AND FITNESS FOR A PARTICULAR PURPOSE SHALL BE LIMITED TO THE DURATION OF THIS LIMITED WARRANTY, OTHERWISE THE REPAIR, REPLACEMENT, OR REFUND AS PROVIDED UNDER THIS EXPRESS LIMITED WARRANTY IS THE EXCLUSIVE REMEDY OF THE CONSUMER, AND IS PROVIDED IN LIEU OF ALL OTHER WARRANTIES, EXPRESS OR IMPLIED. IN NO EVENT SHALL NICOR BE LIABLE, WHETHER IN CONTRACT OR IN TORT (INCLUDING NEGLIGENCE) FOR DAMAGES IN EXCESS OF THE PURCHASE PRICE OF THE PRODUCT, OR FOR ANY INDIRECT, INCIDENTAL, SPECIAL OR CONSEQUENTIAL DAMAGES OF ANY KIND, OR LOSS OF REVENUE OR PROFITS, LOSS OF BUSINESS OR OTHER FINANCIAL LOSS ARISING OUT OF OR IN CONNECTION WITH THE ABILITY OR INABILITY TO USE THE PRODUCT TO THE FULL EXTENT THESE DAMAGES MAY BE DISCLAIMED BY LAW.